

KEY



PATHS AND PATIOS
600x600 concrete paving slabs



CLOSE BOARD FENCE (1.8m high)
1.5m close boarded panels with concrete gravel boards and posts. Fitted with continuous anti lift wire. Gates to match



FRONT GARDENS
600mm knee rail

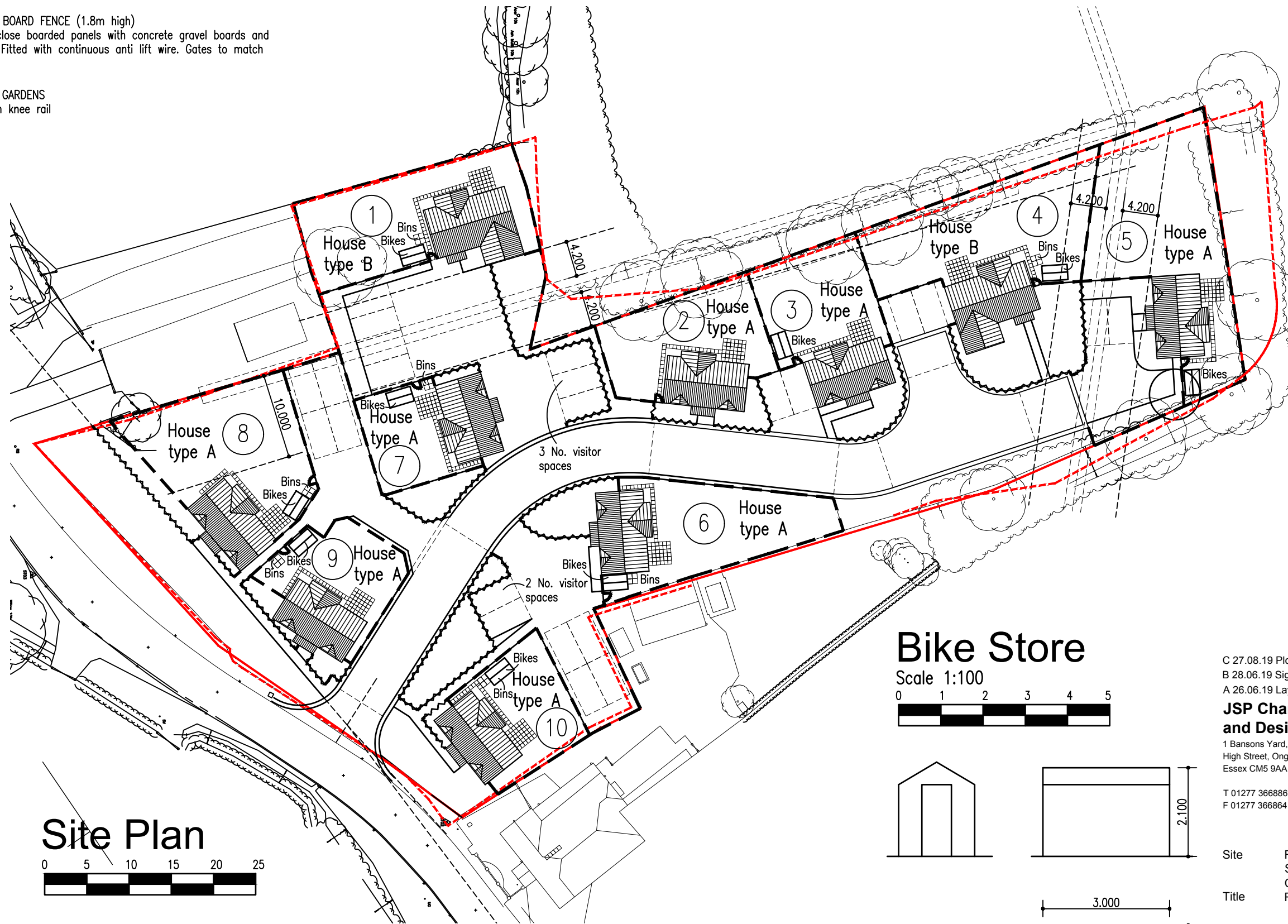
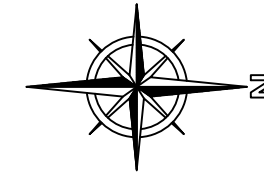

Site Plan

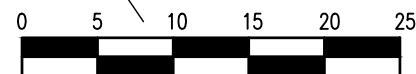

Bike Store

Scale 1:100

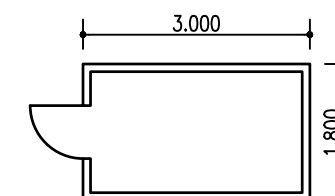
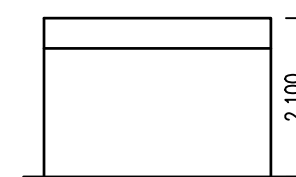
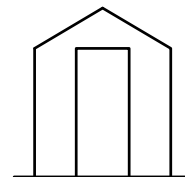
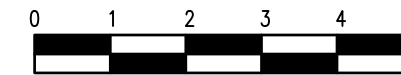

C 27.08.19 Plot 1 house type reference amended
B 28.06.19 Sight lines amended
A 26.06.19 Layout amended

JSP Chartered Town Planners and Design Consultants

1 Basons Yard,
High Street, Ongar,
Essex CM5 9AA

T 01277 366886
F 01277 366864



Site Foster Street Farm, Foster Street, Hastingwood, CM17 9HS
Title Residential Development

Drawing Proposed Site Plan

Scale 1:500 @ A3
Date Dec 2018
Number 2356.2 C