

Proposed total demolition of existing building on site
to be replaced with 2 detached dwellings, 2 semi-detached
and 4 terraced dwellings

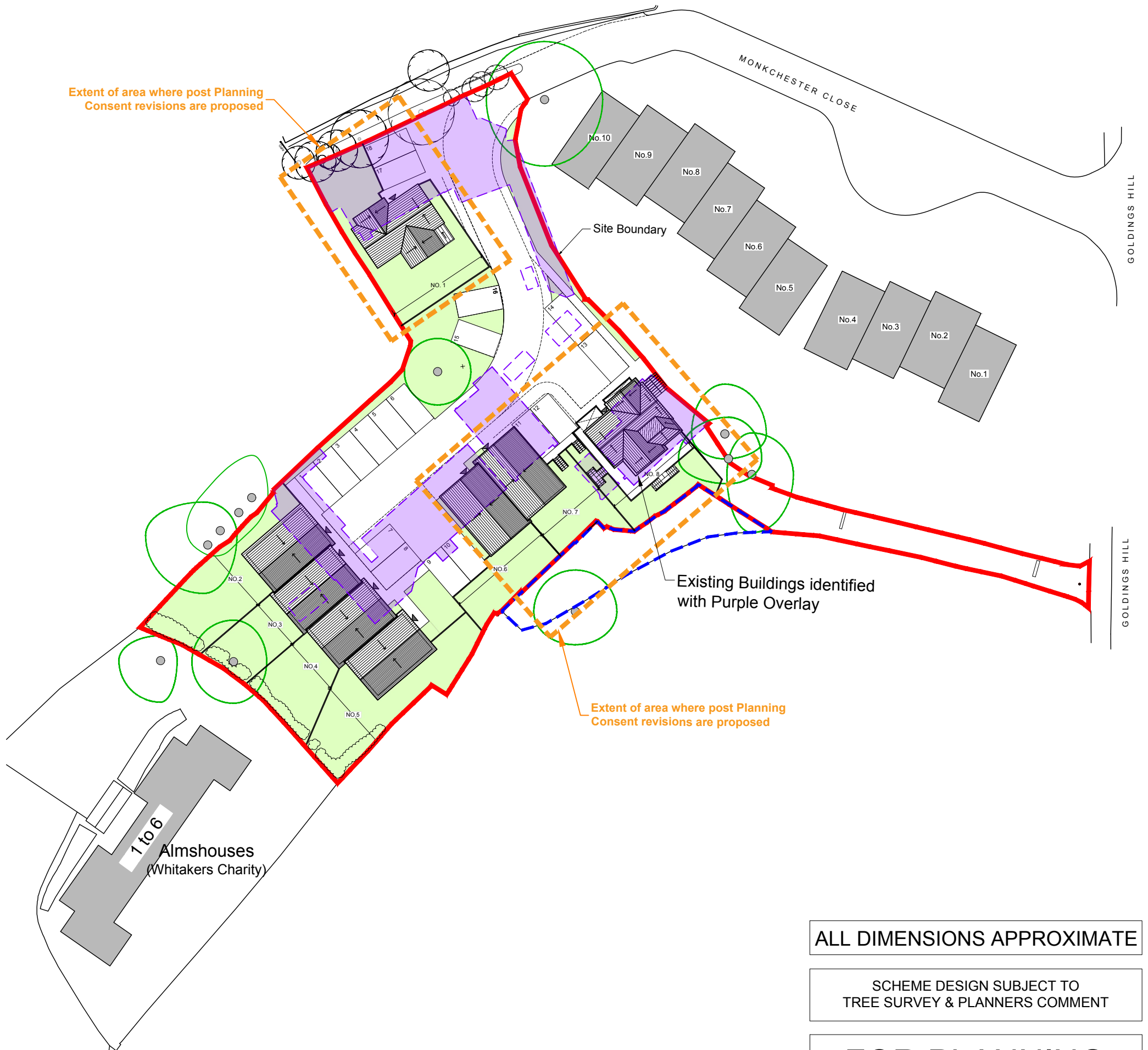

ALL DIMENSIONS APPROXIMATE

SCHEME DESIGN SUBJECT TO
TREE SURVEY & PLANNERS COMMENT

FOR PLANNING

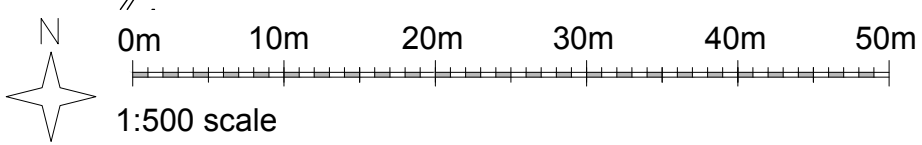

| B | 290817 | Post Planning Consent revisions to Plots | TM |
| A | 260617 | Post Planning Consent revisions to Plot 8 | TM |

BB PARTNERSHIP LTD
CHARTERED ARCHITECTS

THE TRAFALGAR . 17 REMINGTON STREET . LONDON N1 8DH
TEL . 020 7336 8555 FAX . 020 7336 8777
e-mail . architect@bbpartnership.co.uk

© 2010 BB PARTNERSHIP LIMITED
ALL RIGHTS RESERVED

project	Trevelyan House, Goldings Hill Loughton, IG10 2SP	date	APR '16	scale	1:500 @ A3	drawn by	TM
drawing	Proposed Block Plan Overlay	drwg. no	FFK_303	rev	A	B	

. check all dimensions on site ©