

EXISTING GROUND FLOOR PLAN

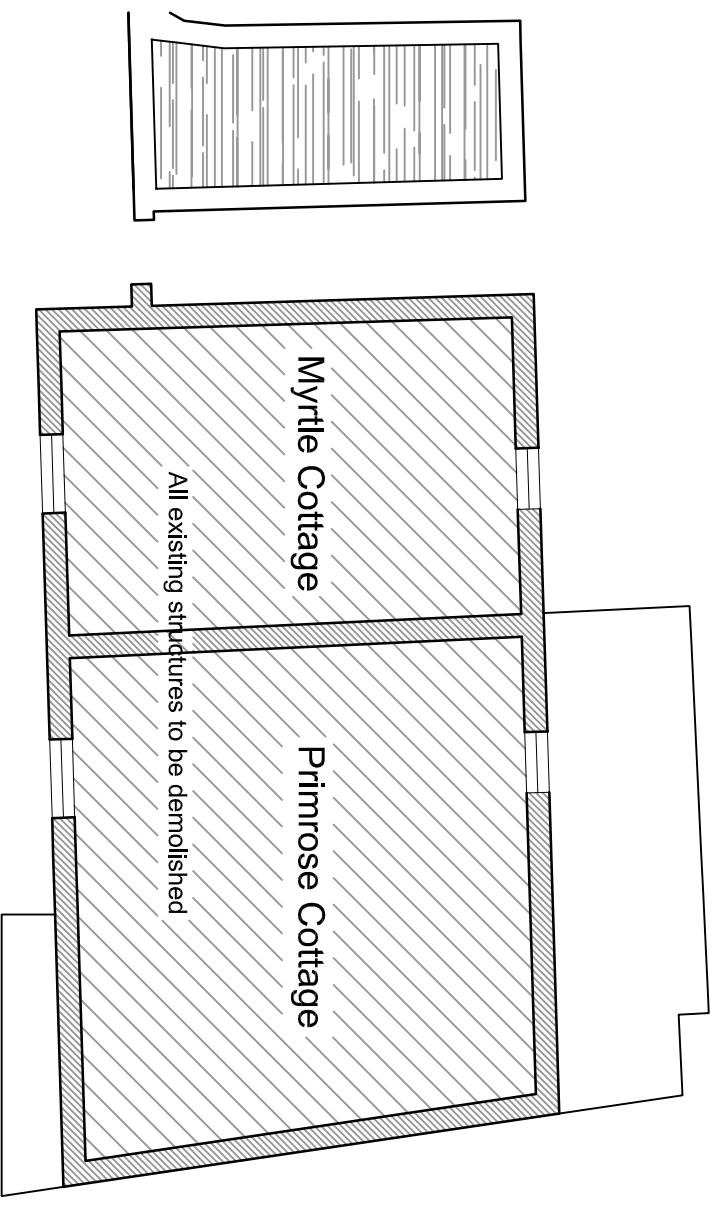

EXISTING FIRST FLOOR PLAN

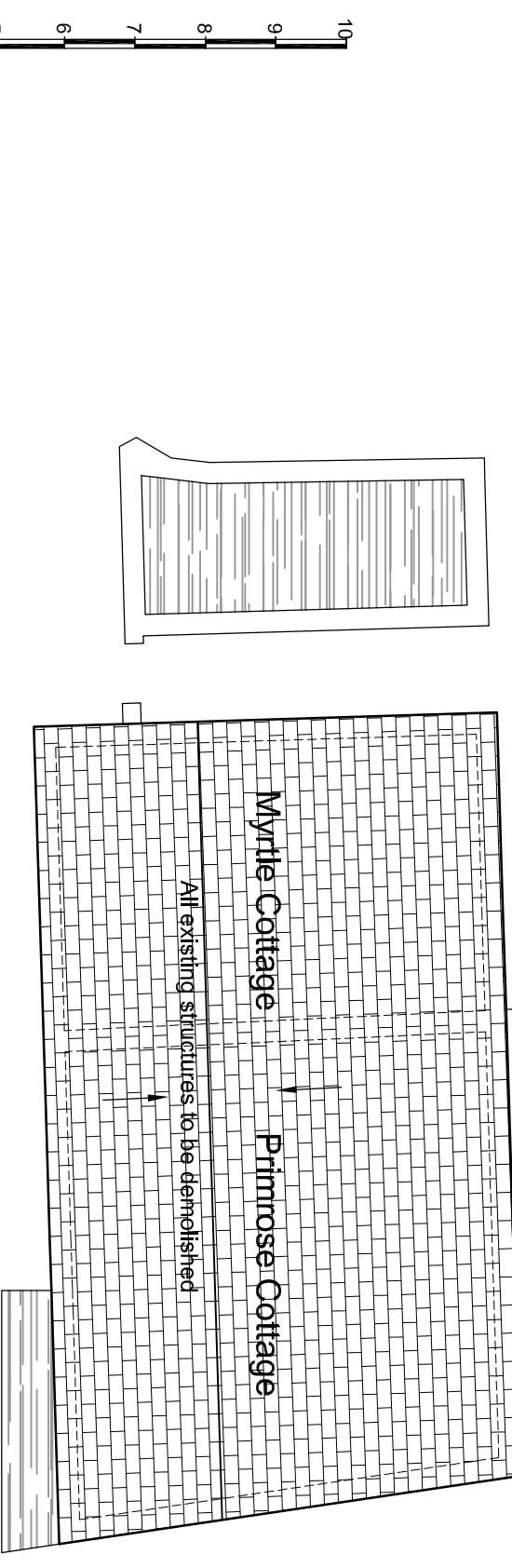

EXISTING ROOF PLAN

- Key
- Existing Walls
  - Existing Walls to be demolished
  - Existing fixtures to be removed
  - Structure over
- Note: All existing services, fixtures and fittings to be removed.

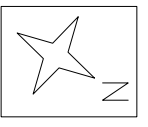

**ALL DIMENSIONS APPROXIMATE**

SCHEME DESIGN SUBJECT TO  
TREE SURVEY & PLANNERS COMMENT

**FOR PLANNING**

<b>BB PARTNERSHIP LTD</b>		project		Trevelyan House, Goldings Hill		date		Mar '14		scale		1:100 @ A3		drawn by		TM	
CHARTERED ARCHITECTS		drawing		Existing Floor plan Myrtle and Primrose Cottages		drwg. no		FFK_105		rev							
THE TRAVAGAR, 17 REMINGTON STREET, LONDON N1 8DH																	
TEL . 020 7336 8555 FAX . 020 7336 8777																	
e-mail . architect@bbpartnership.co.uk																	